



# *Gala at the Great Hall*

**MAKING EDUCATIONAL ACCESS POSSIBLE**



## *Gala at the Great Hall*

MAKING EDUCATIONAL ACCESS POSSIBLE



# *Thank You*

This fall's first-year class is the most academically prepared in Monmouth's 92-year history, boasting a record 3.67 GPA, an average submitted SAT of 1225, and the largest number of Honors School enrollments in University history. At the same time, we welcomed a record number of first-generation and low-income students, with 55.8 percent of the class identifying as first generation or Pell Grant-eligible. These results reflect our mission to integrate excellence and access like few other schools of our kind anywhere.

With your support, we will continue to provide access to deserving students while advancing efforts toward academic, athletic, and artistic excellence. Thank you for joining us to help make educational access possible.





# *The President's Medal Recipient*

## **Marianne C. Hesse**

Marianne C. Hesse has long been a champion of Monmouth University and its students, guided by her commitment to enriching the campus experience. Since her election as trustee in 2007, her support has elevated several major campus facilities, including the OceanFirst Bank Center, Hesse Hall, Hesse Field on the Great Lawn, and Kessler Stadium, enhancing opportunities for students to fully engage in academic and campus life. The Hesse family's enduring relationship with Monmouth reflects her own legacy as well as that of her late husband, Charles J. Hesse III, who also served as a distinguished trustee. Their connection continues through their grandchildren, who proudly carry on the Hawk tradition.

This year, Monmouth University honors Marianne C. Hesse's extraordinary contributions with the President's Medal, one of the University's highest distinctions. Her steadfast service, generosity, and leadership embody the values central to Monmouth's mission, and her lasting impact on the campus community makes her deeply deserving of this recognition.

*Thank You to Our Lead Sponsors & Donors*

**OUTCOME SPONSORS**

Gourmet Dining  
The Hesse Companies  
Torcon, Inc.

**SUMMA CUM LAUDE**

---

Hackensack Meridian *Health*  
OceanFirst Bank  
Stillwell-Hansen Inc. & The Loshiavo Family



## MAGNA CUM LAUDE

---

BSI Corporate Benefits  
The Gerard Family  
Liberty Coca-Cola Beverages  
Joan and Henry D. Mercer, III '87 '17HN

## CUM LAUDE

---

Hilb Group of New Jersey  
IBEW Local 400  
JTC Painting & Decorating  
Kolber Family Foundation  
Monmouth Park Corporate Center 1  
The Montecalvo and Bayshore Family of Companies  
New Jersey Resources  
Trudy and Charlie Parton '01HN  
Plumbers & Pipefitters Local Union #9

## DEAN'S LIST

---

Ansell Grimm & Aaron, PC

Breaker Electric

Greenbaum, Rowe, Smith & Davis LLP

Hall Construction Co.

Estelle and Raymond G. Klose '77

Mari '82 '86M and Kurt Kovach '85

Manasquan Savings Bank

The McKean Family

The Michelli Family

Dr. and Mrs. Tavit and Sossie Najarian

NJM Insurance Group

Norris McLaughlin P.A.

Linda and Michael A. Plodwick '82

RWJBarnabas Health/  
Monmouth Medical Center



# OUTCOME SPONSOR

**Gourmet Dining is proud to serve the  
Monmouth University community &  
support scholarships to deserving students!**

**The Frungillo Family & your partners at Gourmet Dining**

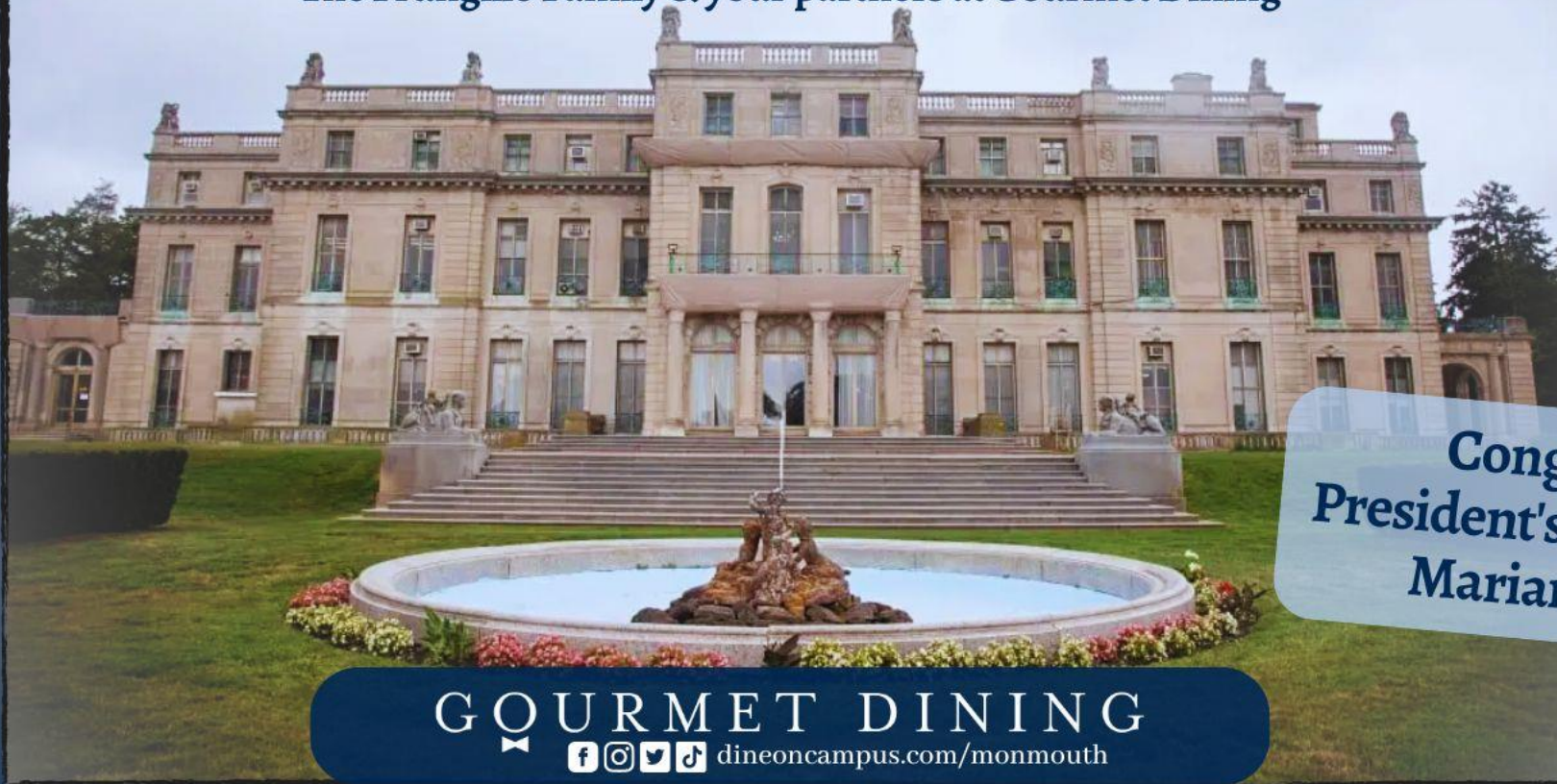

**Congratulations  
President's Medal Recipient  
Marianne C. Hesse**

**GOURMET DINING**



[dineoncampus.com/monmouth](https://dineoncampus.com/monmouth)



# OUTCOME SPONSOR



Construction Managers  
General Contractors

[www.torcon.com](http://www.torcon.com)



Proud to be a  
Strategic Partner of  
Monmouth University

Congratulations  
2025 President's Medal Recipient  
Marianne C. Hesse

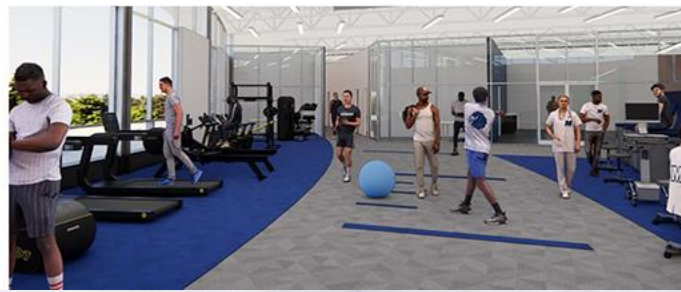
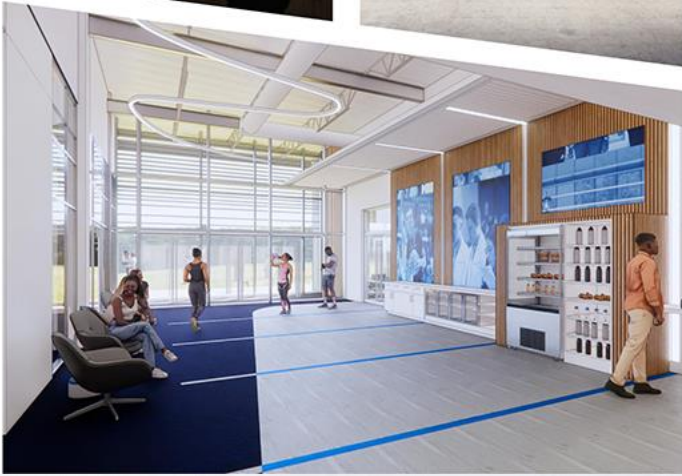



# SUMMA CUM LAUDE SPONSOR

Congratulations to Monmouth University on your **Gala at the Great Hall.**



***We are thrilled to celebrate you and be your partners in collaboration, bringing enhanced wellness and educational opportunities to students, employees and the community at-large.***



**Hackensack  
Meridian Health**

[HackensackMeridianHealth.org](https://HackensackMeridianHealth.org)

# SUMMA CUM LAUDE SPONSOR



Striking Gold Stables and the Loshiavo Family  
are proud to support Monmouth University's  
Gala at the Great Hall

---

Located in beautiful Colts Neck, Owner and Trainer  
Lauren Loshiavo offers boarding, hunter/jumper  
instruction, and therapeutic riding lessons.

To schedule a lesson or learn more, contact  
Lauren Loshiavo at (908) 839-7660 or visit  
**[StrikingGoldStables.com](http://StrikingGoldStables.com)**





SUMMA CUM LAUDE SPONSOR

# PROUD TO SUPPORT OUR COMMUNITY AND MONMOUTH UNIVERSITY



From New Jersey and beyond, as our footprint expands, we're still with you every step of the way.

Call us today at 1.888.623.2633  
or visit us online at [oceanfirst.com](https://oceanfirst.com).

Member FDIC  Equal opportunity lender.  
Equal housing lender. |     





# SUMMA CUM LAUDE SPONSOR



Carol Stillwell and the Stillwell-Hansen family  
are proud to support Monmouth University's  
Gala at the Great Hall in recognition of our  
dearest friend, Marianne C. Hesse.



# MAGNA CUM LAUDE SPONSOR

## Employee benefits **you can count on**

**The needs of universities, colleges, and independent schools are complex.**

The consulting expertise that the BSI team brings to these organizations is uniquely different, driving greater long-term impact than traditional employee benefits firms.

Learn more at [bsicorporate.com](https://bsicorporate.com).

Proud Employee Benefits Sponsor of



**BSI**  
CORPORATE BENEFITS



# MAGNA CUM LAUDE SPONSOR



The Gerard Family  
is proud to support the Monmouth  
University Access Fund in honor of fellow  
Board member and the 2025 President's  
Medal recipient, Marianne C. Hesse.



# MAGNA CUM LAUDE SPONSOR



Joan and Henry D. Mercer III '87 '17HN  
are thrilled to support the Gala at the  
Great Hall in recognition of Monmouth  
University's biggest fan, our dear friend  
Marianne Hesse.

Go Hawks!

# CUM LAUDE SPONSOR



INSURANCE | BENEFITS | HR SOLUTIONS

**Hilb Group is proud to support  
the Monmouth University's Gala**

***Congratulations to Marianne C. Hesse,  
recipient of the 2025 President's Medal***

**Scott Kuzmic, CIC, CRM**

2380 Route 9 | Suite 10 | Howell, NJ 07731

732-995-2162 | [skuzmic@hilbgroup.com](mailto:skuzmic@hilbgroup.com) | [hilbgroup.com](http://hilbgroup.com)



# CUM LAUDE SPONSOR



**PRODUCTIVITY** **CRAFTSMANSHIP**

*IBEW Local 400  
proudly supports the  
Gala at the Great Hall  
Congratulations to Marianne C. Hesse as  
this year's President's Medal Recipient*

---

IBEW Local Union 400  
3301 Hwy 138 East / PO Box 1256  
Wall, NJ 07719

**Robert W. Shimko • Business Manager**  
**Michael J. Ricca • Assistant Business Manager**  
**James P. Moran • Business Agent/Organizer**  
**Robert C. Baumgartner • Business Agent/Organizer**

<b>Michael Ricca • President</b>	<b>Executive Board</b>	
<b>Robert Baumgartner • Vice-President</b>	<b>Rocco Damato</b>	<b>Robert Sullivan</b>
<b>Joseph Vogt • Recording Secretary</b>	<b>Robert Ingman</b>	<b>Dean Carthy</b>
<b>James P. Moran • Treasurer</b>	<b>Lee Sanborn</b>	

# CUM LAUDE SPONSOR



John and Maria Caruso  
are proud to support the Gala at the  
Great Hall in recognition of Monmouth  
University and its students.



# CUM LAUDE SPONSOR



The Kolber Family  
is proud to support Monmouth University  
and to celebrate our dear friend, Marianne  
Hesse, on her well-earned recognition as  
this year's President's Medal recipient.  
We offer our heartfelt gratitude for all you  
have done for the University and for our  
community. Congratulations, Marianne!

George & Vita

# CUM LAUDE SPONSOR

## *Monmouth Park Corporate Center I*



*We are pleased to support  
Monmouth University's  
Gala at the Great Hall*

Carl P. Gross, Esq.

Henry H. Bloom

185 Route 36

West Long Branch, NJ 07764



# CUM LAUDE SPONSOR

*The Montecalvo &  
Bayshore Family*

is proud to support  
Monmouth University in  
honoring Marianne Hesse.



**BAYSHORE**  
Family of Companies

**M** MONMOUTH  
UNIVERSITY

[www.bayshorerecycling.com](http://www.bayshorerecycling.com)



# CUM LAUDE SPONSOR

Proud to Support



**New Jersey Resources is dedicated to making New Jersey  
a better place to live, work and thrive.**

**Building resilient and sustainable communities — together.**



New Jersey Natural Gas | NJR Clean Energy Ventures | NJR Energy Services | NJR Home Services | NJR Storage & Transportation



# CUM LAUDE SPONSOR



Trudy and Charlie Parton '01HN  
are proud to support the 2025 Gala  
at the Great Hall in recognition of  
our dear friend and fellow Board  
member, Marianne C. Hesse.

# CUM LAUDE SPONSOR

**~ Best Wishes ~**

**PLUMBERS AND PIPEFITTERS  
LOCAL UNION NO. 9  
CENTRAL NEW JERSEY**

---



**Business Manager**  
MICHAEL A. TRANBERG

**Assistant Business Manager**  
JOHN E. BOYLE III

**Business Agents**  
EDWARD F. BURNS  
DEAN FEASEL  
MARK REULBACH  
PATRICK M. SCHARNITZ  
CHARLES F. WHALEN IV

**Organizers**  
WILLIAM K. GRAYBUSH  
ROBERT D. FEASEL

**President**  
BRIAN W. THOMS

**Vice President**  
ROBERT J. DILL

**Executive Board**  
MICHAEL BELL  
CHARLES GELOSO  
TODD MONTGOMERY  
THOMAS F. PANCONI, JR.

**There Is No Substitute for Skilled U.A.  
Building and Construction Trades Craftsmen**

**2 IRON ORE ROAD AT ROUTE 33, ENGLISHTOWN, NJ 07726**  
Telephone: (732) 792-0999 • Fax: (732) 792-1999  
Website: [www.ualocal9.org](http://www.ualocal9.org)



# DEAN'S LIST SPONSOR



Monmouth University's commitment to providing greater access to higher education builds stronger communities. We proudly support the Access Fund for Excellence, Access, and Ambition.

Serving New Jersey's Legal Needs for Over 95 Years

(732) 922-1000 • [ansell.law](http://ansell.law)

Princeton, NJ | Woodland Park, NJ | **Ocean Township, NJ** | New York, NY | Newtown, PA

# DEAN'S LIST SPONSOR



Working to Keep your Business, Campus  
or Facility "Connected."

For all of your Power, Data, and Communication Needs  
Established 1987 ~ LIC.#8743

488 Monmouth Road, Clarksburg, NJ 08510  
Phone: 609-208-1818 Fax: 609-208-2145



# DEAN'S LIST SPONSOR



Greenbaum, Rowe, Smith & Davis  
is proud to support  
**Monmouth University's  
Gala at the Great Hall**  
and to join in honoring  
**Marianne C. Hesse**  
*President's Medal Recipient*

[greenbaumlaw.com](http://greenbaumlaw.com)

Iselin | Roseland | Red Bank | New York





# DEAN'S LIST SPONSOR





# DEAN'S LIST SPONSOR



Estelle and Raymond G. Klose '77  
are proud to support the Monmouth  
University Access Fund in honor of  
fellow Board member and friend,  
Marianne C. Hesse.

DEAN'S LIST SPONSOR

**GTS**

**GENERAL TECHNICAL SERVICES**



# DEAN'S LIST SPONSOR



**MANASQUAN  
BANK**

*est. 1874*

# DEAN'S LIST SPONSOR



The McKean Family



# DEAN'S LIST SPONSOR



The Michelli Family  
is proud to support the Monmouth  
University Access Fund in honor of  
longtime fellow Board member, friend,  
and the 2025 President's Medal recipient,  
Marianne C. Hesse.



**MICHELLI FAMILY  
FOUNDATION**

# DEAN'S LIST SPONSOR

CONGRATULATIONS!

*Marianne C. Hesse*

2025 President's Medal recipient

*Dr. & Mrs. Tavit and Sossie Najarian*



*We proudly recognize Monmouth University for their service to higher education!*

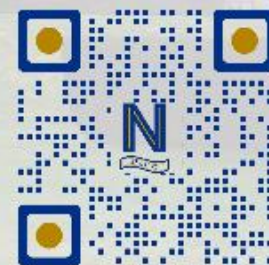



# DEAN'S LIST SPONSOR



HAVE CONFIDENCE IN YOUR  
COVERAGE WITH NJM.

NJM Insurance Group  
is proud to support

## **Monmouth University's Gala at the Great Hall**

and congratulates this year's honoree

**NJM** Insurance  
Group

AUTO. PROPERTY. BUSINESS.

FOR A QUOTE, VISIT [NJM.COM](https://www.njm.com)  
OR CALL 1-800-232-6600

# DEAN'S LIST SPONSOR



Norris McLaughlin, P.A. proudly supports...

## MONMOUTH UNIVERSITY: GALA AT THE GREAT HALL

Norris McLaughlin, P.A. offers high-quality, comprehensive legal services clients expect and value.



NICHOLAS F. PELLITTA

**Higher Education • Litigation • Bankruptcy • Business Law  
Elder Care • Trusts & Estates • Environmental Law  
Health Care & Life Sciences • Intellectual Property  
Labor & Employment • Liquor Law  
Litigation • Mergers & Acquisitions  
Real Estate & Finance • Tax Counseling**

 **908.722.0700**



**[norris-law.com](http://norris-law.com)**





# DEAN'S LIST SPONSOR



The Plodwick family  
is proud to support the 2025 Gala at  
the Great Hall in recognition of dear  
friend and fellow Board member,  
Marianne C. Hesse.

## DEAN'S LIST SPONSOR

Monmouth Medical Center proudly supports  
**Monmouth University's Gala at the Great Hall**  
and congratulates honoree Marianne C. Hesse.

**RWJBarnabas**  
**HEALTH**

**Monmouth**  
**Medical Center**



THANK YOU TO OUR SPONSORS



*Senator Declan  
O'Scanlon*

---

CLASS OF '86

---

As a Monmouth Alumnus, I'm proud to support the 2025 Gala at the Great Hall's efforts to break down financial barriers our community's future leaders may be facing to their academic goals.



# THANK YOU TO OUR SPONSORS



We are proud to support Monmouth University students through the Gala at the Great Hall and to help ensure that a Monmouth education remains accessible for deserving students.

Karen and Tom Stackhouse



# THANK YOU TO OUR SPONSORS



NEWPORT CAPITAL GROUP



MONMOUTH  
UNIVERSITY

Newport Capital Group is proud to support the

## **Monmouth University Gala at the Great Hall**

Retirement Plan Solutions

Private Wealth

Foundations & Endowments

The current written disclosure statement for Newport Capital Group, LLC, a SEC registered investment adviser, discussing its advisory services and fees, remains available upon request.  
SEC registration does not constitute an endorsement of the firm by the Commission, nor does it indicate that the adviser has attained a particular level of skill or ability.

THANK YOU TO OUR SPONSORS

# BLACKSWALLOWTAIL STUDIOS

***We Make Modern Marketing Easy***

*Streamlined Media Production & Marketing Solutions*

State-of-the-art studio facilities, a professional production team,  
and strategic marketing expertise—all under one roof.

Production and marketing working in perfect sync: efficient, creative, and results-driven.

**Let's Discuss Your Marketing Strategy!**

BLSWSS.com • 732-934-2710





# THANK YOU TO OUR SPONSORS



**261 North 18th St • East Orange, NJ 07017**  
**TEL: (973) 414-9200 • FAX: (973) 414-8440**  
**AmericanWear.com**



Debbie and Tom '82 '86M Porskievies are pleased to honor Marianne C. Hesse and fondly remember Charles J. Hesse III as Monmouth University celebrates their decades of generosity in support of Excellence, Access, and Ambition.

# THANK YOU TO OUR SPONSORS



## *Villa Tre Angeli*

Experience Italy like an Italian!

### Private Tours at the Villa

Discover an authentic Italian lifestyle in a quaint village steeped in tradition.

#### Includes:

- Pick up/Drop off at the Malpensa Airport in Milan
- Dinner upon arrival
- All ground transportation
- A seven-night stay at the Villa
- Five days worth of tours
- All breakfasts

- Appetizers one evening at the Villa
- One classic Italian lunch
- Entrance fees
- One free day to explore on your own
- A local guide fluent in Italian and English

#### 1 - 4 People

\$4,750 Double Occupancy  
\$5,750 Single Occupancy

#### 5 or More People

\$3,950 Double Occupancy  
\$4,950 Single Occupancy

Price ~~PER PERSON~~  
Flight not included

### Custom Tours - Anywhere Else in Italy

Your dream destination, our seamless planning!

#### 1 - 4 People

\$5,950 Double Occupancy  
\$6,950 Single Occupancy

#### 5 or More People

\$5,150 Double Occupancy  
\$6,150 Single Occupancy

Price ~~PER PERSON~~  
Flight not included

#### Includes:

- Pick up/Drop off to any airport of your choice
- All ground transportation (public & private)
- 7-night stay in a 4-star hotel
- All breakfasts
- One wine and cheese night
- All tours
- All entrance fees
- All Fast Pass tickets (where applicable)
- One authentic family-style meal
- One walking/food tour
- An English/Italian speaking guide



Call Valerie to book your tour today!

(732) 927-0610

[www.VillaTreAngeli.com](http://www.VillaTreAngeli.com)







**SAVE THE DATE | JUNE 15, 2026**

*Metedeconk National Golf Club*

President Patrick Leahy invites you to save the date for the  
**Monmouth University Golf Outing**, slated for June 15, 2026.

This marquee outing also features: numerous luxury experiences available at auction;  
on-site competitions; exclusive networking with distinguished alumni, community, and business leaders;  
and most importantly, the opportunity to make a lasting impact in the lives of over 600 student-athletes.

**[monmouth.edu/golfouting](https://monmouth.edu/golfouting)**

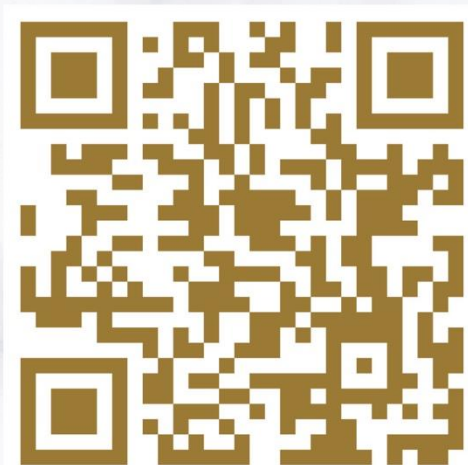

To see photos from tonight's event, visit:  
[flic.kr/s/aHBqjCCAkC](https://flic.kr/s/aHBqjCCAkC)





# *Thank You*

**FOR MAKING EDUCATIONAL ACCESS POSSIBLE WHILE SUPPORTING  
THE “EXCELLENCE. ACCESS. AMBITION.” CAMPAIGN.**

The Access Fund provides scholarship support for students with unmet financial need, helping to ensure a Monmouth education remains accessible to the most deserving students year after year.

To view the full Digital Ad Journal, please scan this QR code

